

Dec 10-1888

✓ S. E. 1/4 Sec 14 T5N R2W

244

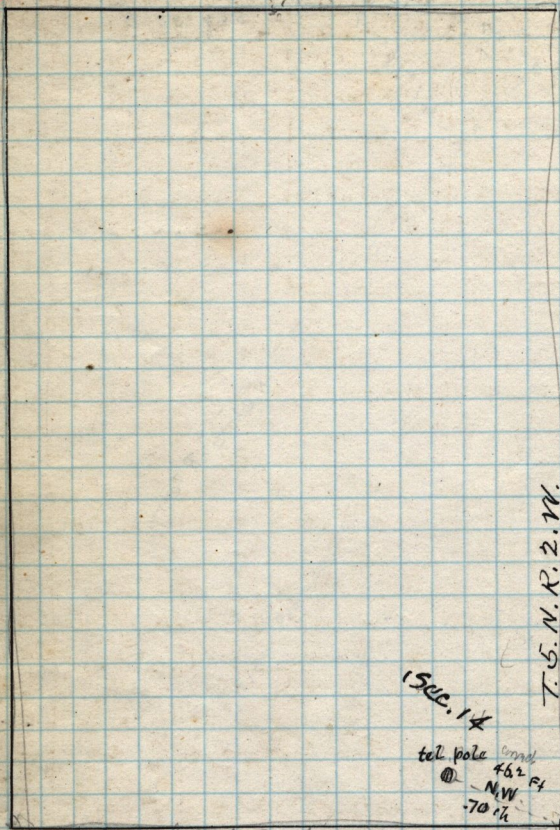

T. 5. N. R. 2. W.

1 Sec. 14

tel. pole cond
462 Ft
N.W.
70 ft

Center of County Road

ch = 32.34

.49
S.W.E.

Sec. 23 da tel. pole

0-04-50
73-41
73-49-20

Red
SE
Inde
111
as